

PTFE EXPANSION JOINT  
NOT SUPPLIED  
FOR REFERENCE ONLY

1 2 3 4

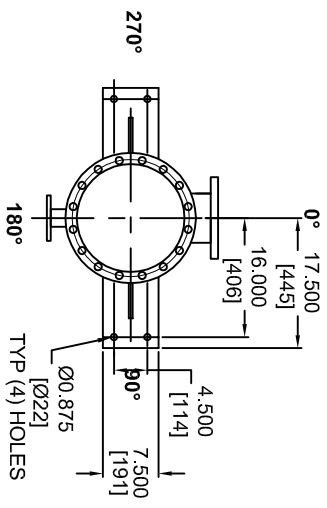

300 A 10K  
FLANGE CONNECTION  
HCL INLET / OUTLET  
400MM BCD / (16) 25 Ø  
BOLT HOLES

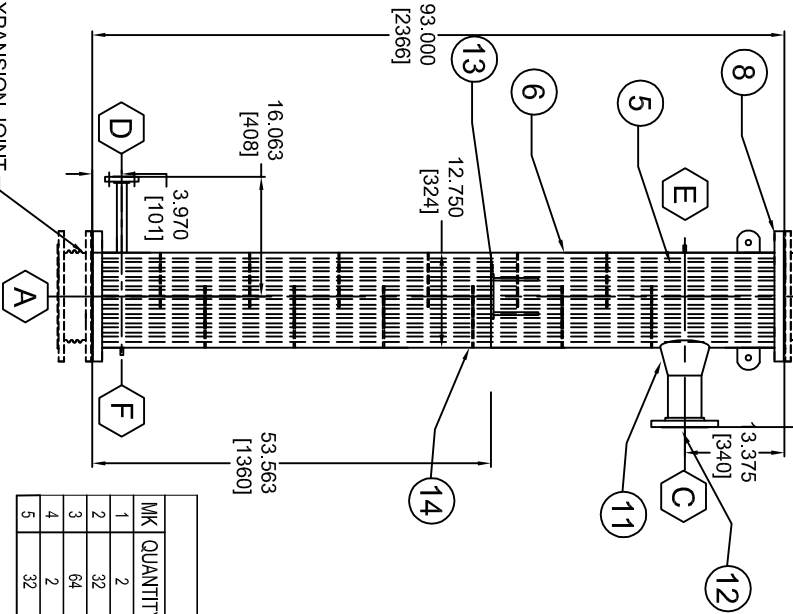
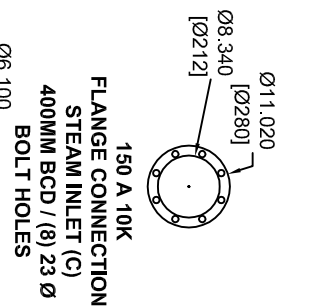

150 A 10K  
FLANGE CONNECTION  
STEAM INLET (C)  
400MM BCD / (8) 23 Ø  
BOLT HOLES

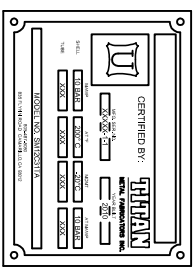

NAMEPLATE  
DETAILS

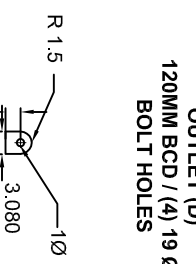

LIFTING LUG  
DETAIL

MK	QUANTITY	DESCRIPTION	MATERIAL OF CONSTRUCTION	COMMENTS
1	2	300A X 3 CONVOLUTION EXPANSION JOINT	PTFE BELLOWS/ CS FLANGES	SUPPLIED BY CUSTOMER
2	32	M220 X 110MM LONG STUDS	SA-193-B7	SUPPLIED BY CUSTOMER
3	64	M22 HEX NUT	SA-193	SUPPLIED BY CUSTOMER
4	2	300A 10K X 3MM THICK RING GASKET	GYLON 3504	SUPPLIED BY CUSTOMER
5	32	M22 FLAT WASHER	CS	SUPPLIED BY CUSTOMER

NOZZLE SCHEDULE

MK	SIZE	RATING	TYPE	SERVICE	REMARK
A	300A	10K	RFSO	HCL LIQUID INLET	---
B	300A	10K	RFSO	HCL LIQUID OUTLET	---
C	150A	10K	RFSO	STEAM INLET	---
D	50A	10K	RFSO	CONDENSATE OUTLET	---
E	19A	3000#	NPT	SHELLSIDE VENT	W/ PLUG
F	19A	3000#	NPT	SHELLSIDE DRAIN	W/ PLUG

TOLERANCES  
(UNLESS OTHERWISE SPECIFIED)  
TOLERANCES ARE NOT ACCUMULATIVE

DECIMAL .032"  
FRACTION 1/16"  
ANGLE 1/2°  
GENERAL: 125°  
DECIMAL .125"  
FRACTION 1/8"  
ANGLE 1°

DATE	BY	DESCRIPTION
2010/01	JM3132/TAST	2PL PICKLING TANK HEAT EXCHANGER

DESIGN CONDITIONS	DESIGN PRESSURE	DESIGN TEMPERATURE	CORROSION ALLOWANCE	RADIOGRAPHY	WELD EFFICIENCY	HEAT TREATMENT	HYDRO TEST PRESS.	WEIGHT EMPTY
BAR	10	-20° / 200°	1.5	NONE	.70	NONE	BAR	776 LBS

MATERIALS OF CONSTRUCTION	TUBES	SHELL	TUBESIDE	QUANTITY
(5) TUBES	SA-1088	SA-1088	SA-1088	1
(6) SHELL	SA-1088	SA-1088	SA-1088	1
(7) BONNETS	SA-1088	SA-1088	SA-1088	0
(8) TUBESHEETS / LINERS	SA-516-70	SA-516-70	SA-516-70	2
(9) BODY FLANGES	SA-1088	SA-1088	SA-1088	0
(10) FLAT HEADS	SA-1088	SA-1088	SA-1088	2
(11) NOZZLE NECKS	SA-1088	SA-1088	SA-1088	2
(12) NOZZLE FLANGES	SA-1088	SA-1088	SA-1088	2
(13) SUPPORTS	SA-1088	SA-1088	SA-1088	2
(14) BARRELS	SA-1088	SA-1088	SA-1088	2
(15) GASKETS	SA-1088	SA-1088	SA-1088	2

TEAM TYPE	TEAM CLASS	TEAM
TEAM TYPE: BEM	TEAM CLASS: B	TEAM: POSO

CLIENT	PROJECT	DATE
CLIENT: JEDMAN - SOUTH KOREA	PROJECT: SM2C31TA	DATE: 2010/01

This document is proprietary. The information contained in this document is confidential and is not to be used, reproduced, or disclosed, in whole or in any part, to any third party without the written permission of Trihan Metal Fabricators, Inc. It is subject to return upon request.